



# SOUTHPARK MALL

MOLINE, IL

## MARKET PROFILE 2023

**MAJOR RETAILERS** Ashley Furniture, Dick's Sporting Goods, Dillard's, JCPenney, Shoe Dept. Encore, Von Maur

**RESTAURANTS & ENTERTAINMENT** Arby's, Buffalo Wild Wings, Habanero's, KFC, Olive Garden, Taco Bell

**PROPERTY TYPE** Regional | **TOTAL SQUARE FEET** 854,000 | **BUILT / RENOVATED** 1974 / 2014

**FOR MORE INFORMATION** 309-797-8450 | [Macerich.com](https://www.macerich.com)



# DEMOGRAPHIC SUMMARY

POPULATION		PRIMARY TRADE AREA		TOTAL TRADE AREA		DAVENPORT-MOLINE-ROCK ISLAND, IA-IL [MSA]	
2022 Total Population		131,962		278,277		383,528	
2027 Total Population		129,523		276,039		381,128	
2022-2027 Population Growth		-1.8%		-0.8%		-0.6%	
HOUSEHOLDS							
2022 Total Households		55,687		115,729		159,378	
2027 Total Households		54,913		115,315		159,061	
2022-2027 Household Growth		-1.4%		-0.4%		-0.2%	
INCOME							
Average Household Income		\$78,852		\$88,803		\$90,315	
Median Household Income		\$60,722		\$64,634		\$65,491	
Per Capita Income		\$33,317		\$36,998		\$37,576	
HOUSEHOLD INCOME RANGES							
\$50,000 +		33,103	59.4%	72,254	62.4%	100,339	63.0%
\$75,000 +		23,069	41.4%	50,877	44.0%	70,979	44.5%
\$100,000 +		15,139	27.2%	35,580	30.7%	49,921	31.3%
\$150,000 +		4,470	8.0%	13,198	11.4%	19,165	12.0%
AGE							
Median Age		41.5		41.4		41.2	
EDUCATION / OCCUPATION							
Bachelor’s Degree Plus		22,868	25.5%	57,443	30.4%	77,727	29.8%
White Collar		32,362	48.1%	73,476	51.1%	102,462	51.6%
RACE/ETHNICITY							
White		90,532	68.6%	210,538	75.7%	298,203	77.8%
Black/African American		16,587	12.6%	25,417	9.1%	32,081	8.4%
American Indian		760	0.6%	1,267	0.5%	1,512	0.4%
Asian		4,142	3.1%	7,802	2.8%	9,380	2.4%
Pacific Islander		45	0.0%	91	0.0%	124	0.0%
Other Race		19,897	15.1%	33,162	11.9%	42,228	11.0%
Hispanic or Latino		19,373	14.7%	29,200	10.5%	35,598	9.3%
Not Hispanic or Latino		112,589	85.3%	249,078	89.5%	347,930	90.7%
EMPLOYMENT / DAYTIME POPULATION		1 MILE		3 MILE		5 MILE	
Total Businesses		401		2,153		4,598	
Total Employees		7,691		30,129		69,471	
Daytime Population		5,790		56,162		129,929	

# TRADE AREA MAP

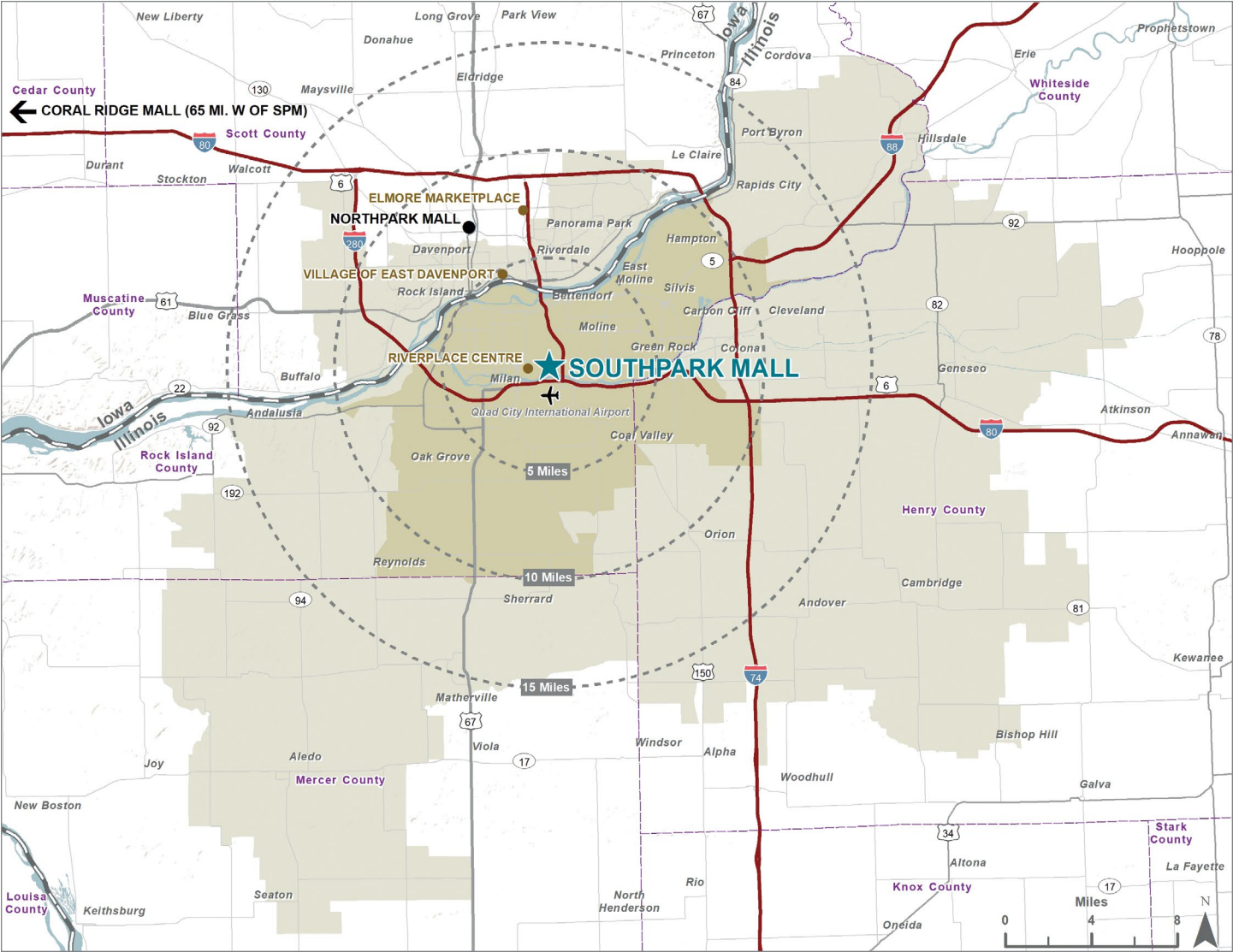

## LEGEND

- ★ SOUTHPARK MALL
- PRIMARY TRADE AREA
- SECONDARY TRADE AREA
- COMPETITIVE CENTERS
- OTHER CENTERS



10% PCW

# SITE PLAN

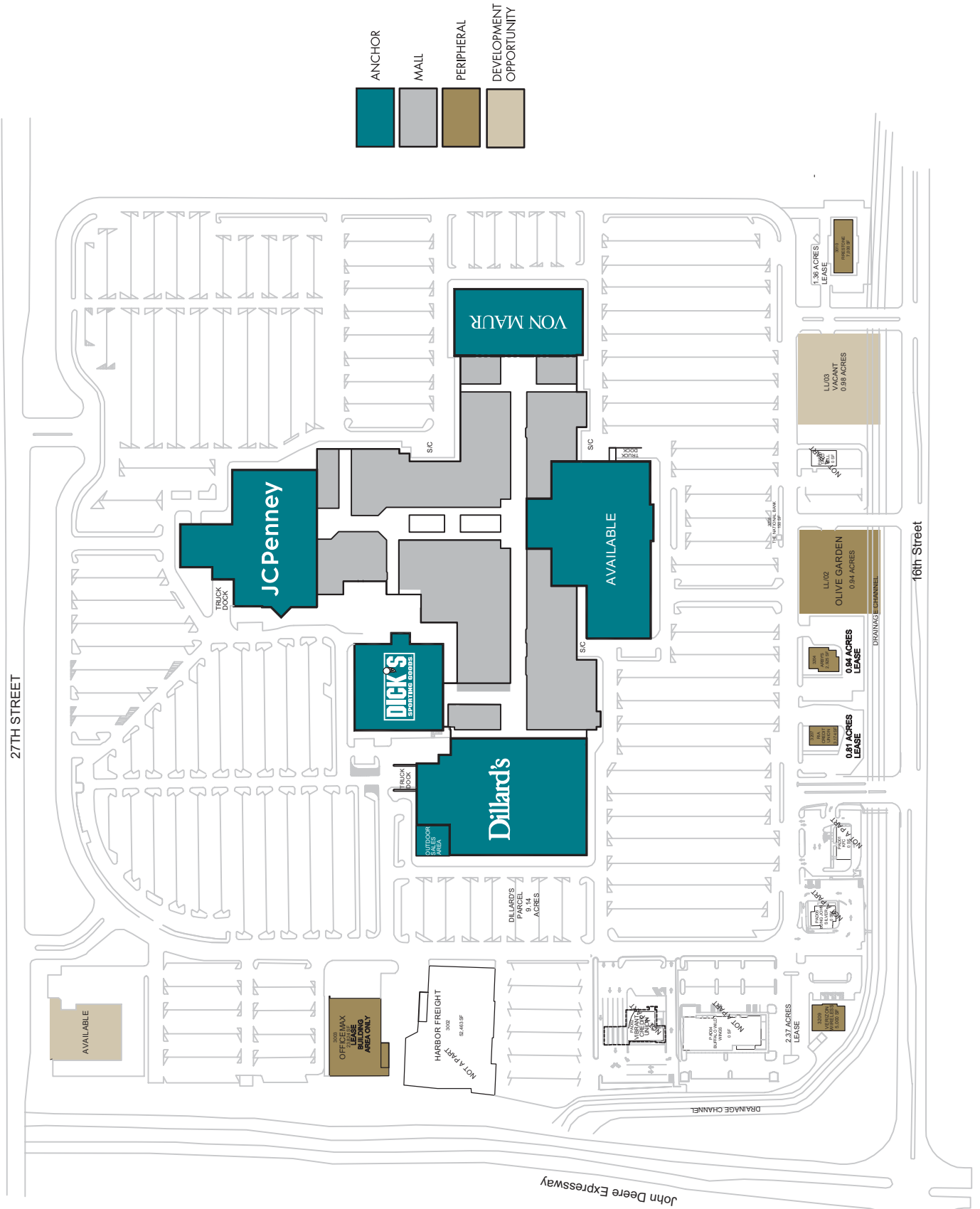



# MARKET FACT SHEET

PEOPLE AND BUSINESSES  
HERE ENJOY THRIVING  
**QUALITY OF LIFE**  
AMENITIES, STRONG  
SCHOOL SYSTEMS  
AND AN AFFORDABLE  
COST OF LIVING

QUAD CITIES  
INTERNATIONAL AIRPORT  
SERVES MORE THAN  
**560,900 PASSENGERS  
AND VISITORS**  
AND IS COMPLETING  
A \$40 MILLION  
IMPROVEMENT PROJECT

SOUTHPARK MALL IS  
LOCATED OFF OF I-74 AND  
JOHN DEERE EXPRESSWAY  
WHICH HAVE AVERAGE  
DAILY TRAFFIC OF  
**41,000 VEHICLES**

MOLINE IS THE WORLD  
HEADQUARTERS OF  
FORTUNE 500 COMPANY  
JOHN DEERE & COMPANY WITH  
**6,000 EMPLOYEES**  
  
IN 2022, THE REGION'S ANNUAL  
**TOURISM SPEND WAS**  
**\$958 MILLION AND**  
**4.5 MILLION VISITS**

PGA TOURNAMENT  
OF THE YEAR, JOHN  
DEERE CLASSIC,  
CONTRIBUTES  
**\$54 MILLION**  
**ANNUALLY TO**  
**THE ECONOMY**

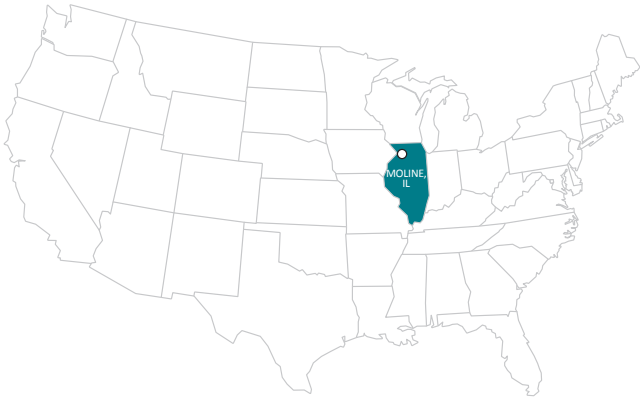

WITHIN 5 MILES  
OF SOUTHPARK  
  
– NEARLY **5,000 COLLEGE  
STUDENTS** BETWEEN BLACK  
HAWK COLLEGE AND WEST  
ILLINOIS UNIVERSITY-QUAD CITIES  
  
– **12,000-SEAT ARENA** HOSTING  
MULTIPLE SPORTING AND  
ENTERTAINMENT EVENTS  
  
– 10 PRIMARY SCHOOL  
DISTRICTS WITH MORE  
THAN 26,000 STUDENTS

ROCK ISLAND ARSENAL HAS A **\$1.7 BILLION ECONOMIC IMPACT**  
AND SUPPORTS OVER 54,000 MILITARY, CIVILIAN AND FAMILY MEMBERS  
  
ACROSS THE STREET, **UNITYPOINT** FEATURES EXPRESS CARE, FAMILY  
MEDICINE AND PEDIATRICS  
  
2 MILES AWAY, QUAD CITIES REHABILITATION INSTITUTE OFFERING  
24-HOUR CARE AND PHYSICAL, OCCUPATIONAL AND SPEECH THERAPIES

## YEARLY SALES

JAN	6.33%	MAY	7.96%	SEP	8.45%
FEB	7.37%	JUN	8.93%	OCT	6.83%
MAR	9.24%	JUL	7.44%	NOV	8.58%
APR	8.15%	AUG	8.27%	DEC	12.44%



# SOUTH PARK MALL

## MAJOR RETAILERS INCLUDE:

DILLARD'S  
JCPENNEY  
DICK'S SPORTING GOODS  
VON MAUR

ARBY'S  
ASHLEY FURNITURE  
BATH & BODY WORKS  
HIBBETT SPORTS

MAURICES  
OLIVE GARDEN  
RUE21  
SHOE DEPT. ENCORE

