

TECHNICAL CRITERIA

LOS CERRITOS CENTER



MACERICH® THE PLACE TO SHOP

ADDENDUM LOG

October 2008	At grade level electrical conduit is not allowed to be installed in the slab (t5)
Revision	
January 2009	December, 2014
Content/Image Revisions	Wiring Language updated (t5, #9)
February 2009	January, 2015
Minor, specific content change (t8)	Language regarding the waterproofing membrane on page t19 revised. (t9)
March 2009	March, 2015
Technical addendum revision - NP info change	Updated Plumbing content to list specific location for main water shut off valve to be at eye level. (t9)
April 2009	May, 2015
Revised KSS rendering	Added language regarding roof mounted equipment cannot be visible from the parking lot. (t8 #8)
July 2010	Detail on t13.
Mechanical content added (pg t7 - HVAC info point 1)	Added updated drawing (t13)
April 2011	March, 2016
Weatherhead requirement added (t7)	Added Electric / Water Sub-meter Requirements (t4)
May 2011	April, 2016
Updated logo	Added Water Efficiency language (t10)
June, 2011	April, 2017
Plumbing content updated to include revised Seismic Gas Shutoff Valve content (t9)	Removed language regarding Telephone Service (t5)
September, 2011	Replaced with language regarding Communications Services (t5)
Waterproof membrane requirement updated	
December, 2011	
Duct detector info added to page t7	
July, 2012	
Power Source info updated (t4)	
December, 2012	
Roof Top Equipment information updated per GE	
Updated Gas Shut-off Valve language (pg. t9)	
March, 2014	
Distribution of utilities through exit corridors is prohibited with exception (t11)	
October, 2014	
Added Solar Panel language (t6)	

LOS CERRITOS CENTER

PLEASE VISIT
WWW.MACERICH.COM

TO VIEW
PLAN SUBMITTAL & APPROVAL
PROCEDURES
and CONTRACTOR RULES &
REGULATIONS

TABLE OF CONTENTS

Electric / Water Sub-meter Requirements	t4
Electrical & Communications Services	t5-t6
Mechanical Criteria	t7 - t9
Plumbing Criteria	t10-t11
Structural Criteria & Exit Corridors	t12
Fire Life Safety Criteria	t13
Technical Criteria Addendum	
Los Cerritos Expansion	t14

LOS CERRITOS CENTER

ELECTRIC/WATER SUBMETER REQUIREMENTS

As applicable for property, if there is an existing electric or water sub-meter in the Tenant's space, then the Tenant must have the meter recommissioned to ensure proper installation and functionality. Alternatively, the Tenant can choose to install a new meter that meets Macerich's meter specifications. Either option must be performed by a Landlord-approved electrician and verified by Macerich, and will be at the Tenant's sole cost.

METER SPECS

Tenant may install the meter specified by Macerich or the like. Meter must meet the following criteria:

Electric:

- Meters must be revenue grade.
- There must be at least a 6-digit display.
- Meter must be able to read demand (kW) and usage (kWh).
- The meter must capture the electric usage of the entire Tenant space, including HVAC units. If this is not possible, then it must be noted.
- If using a meter with CTs, note if a multiplier is required and what the multiplier is on the face of the meter.

Water:

- Meter must be properly sized for the water flow in the space. Generally this means the size of the meter should match the size of the water line, or the meter can be 1/4" smaller than the line. This means that if there is a 1" water line servicing the space, a properly sized meter would be 3/4" or 1".

Installation Requirements:

- Meters must be installed by a Landlord approved electrician.
- Installation must be verified and approved by the Operations Manager, or a member of the Operations staff, at the property.
- Proof of inspection must be sent to the Energy Management Department (Alaine Marx, alaine.marx@macerich.com) and should include the following:
 - * Date of installation or recommissioning
 - * Picture of the meter at time of installation or recommissioning.
 - * Picture should be clear and should display kWh and kW legibly.
 - * Confirmation that the meter covers whole tenant space.
 - * Meter make and model
 - * Units that the meter reads in
 - * Multiplier, if applicable

ELECTRICAL CRITERIA

LOS CERRITOS CENTER

General Design/Construction Coordination

The electrical criteria is provided for the purpose of designing the Tenant's electrical system. This criteria is provided as a guideline for Tenant's Engineer. It is the Tenant's responsibility to verify existing conditions and comply with all applicable codes and standards.

- Conduit and raceway hangers, clamps, light fixtures, junction boxes, supports, etc. must be fastened to joists and/or beams. Do not attach directly to the slab, roof deck, ductwork, piping or conduit above.
- Tenant's equipment in the Mall electric room must be clearly identified with Tenant's name and space number.
- Provide access panels at all junction boxes locations and at smoke detectors above the ceiling.
- All outlet boxes, floor boxes, wire raceways, power/telephone poles, plug-in molding, wiring devices, hanger supports and other items required for a complete distribution must be furnished and installed by Tenant.
- Furnish and install power to roof top units, water heater, store fixtures, signage, music systems and any other fixtures or equipment provided by Tenant. Any roof cutting and patching by mall's required roofer at Tenant's expense.
- All wiring must be copper and in conduit. Low voltage wiring must be in conduit.
- System ground is to be building steel. Structure is designed with a "UFER" grounding system.
- Transformers shall be installed below finished ceilings. They may not be anchored to or suspended from the existing Mall structure, exterior or demising walls.
- Conduit is existing or may be provided by the Landlord from a point of distribution to the Tenant's demised premises.
- The electrical circuit breaker (main breaker) for the Tenant will be furnished and installed by the Landlord at the Tenant's expense.
- The Tenant is responsible for all electrical work within the Tenant's space.
- The Tenant provides wiring through the conduit from the Landlord's point of distribution to the Tenant's space.
- The electrical service size requested by Tenant is subject to approval by Landlord.
- The Tenant will confirm the size of the existing electrical service and ensure that it is satisfactory for the Tenant's conditions before work commences.
- If the Tenant's electrical requirements exceed the standard size provided by the Landlord, the Tenant will submit total Load Calculations to confirm their requirement.
-

Complete Engineered drawings must be submitted to the Landlord's Tenant Coordinator for review and approval. Landlord will review the plans for conformance to basic mall requirements. The Landlord does not review for electrical design, nor does the Landlord accept responsibility for the Tenant's adherence to governing codes.

The documents to be submitted for Landlord approval must include the following:

1. Complete plans and specifications for all electrical work, including lighting, power and one line riser Diagram. Documents must be signed and sealed by a Licensed Engineer in the state where the Shopping Center is located.
2. Floor plan, including branch circuiting and all equipment locations.
3. Reflected ceiling plan, including light fixture layout and lighting fixture schedule.
4. System one line diagram.
5. Electrical load summary and Panel board schedules, showing the connected load on each circuit and the total connected load.
6. Drawings must include panel schedules, load calculations and meter information.
7. Structural drawings must be submitted for all equipment that will be suspended from the steel structure.

ELECTRICAL CRITERIA

LOS CERRITOS CENTER

CONTINUED

Power Source

All work required to connect Tenant to the main power source must be performed by Landlord's designated electrician, at Tenant's expense. Exceptions to this requirement may be granted by the Tenant Coordinator.

Tenant is responsible for feeders to the tenant space, installation of a dry type transformer, panels and complete distribution throughout the tenant space. A General Electric demand check meter must be installed in the mall electric room. Tenant is responsible to arrange for electrical service and meter with utility company at Tenant's expense.

Landlord will provide the main power source for Tenant's connection. Power source will be 277/480v or 120/280v, 3 phase, 4 wire and will be available in the nearest mall electric room. Tenants are responsible for installation of the fused bus duct disconnect switch and must pull the feeder wires to the Tenant's demised premises. Landlord will provide an empty conduit with pull-wire from the mall electric room to the Tenant space. If a larger conduit is required, Tenant is responsible for installation of same from the power source to the demised premises.

Communications Services

1. Landlord has installed a high-speed fiber infrastructure at the Center for purposes of providing voice and data access throughout the Center. All access for Tenant's

voice and data services must be sourced through Landlord's designated provider which is currently Granite Telecommunications or such alternative provider as designated by Landlord. The vendor contact for voice and data services can be found in the Tenant Criteria Package under General Information.

2. For all wiring needs in common electrical rooms, a required vendor must be used to maintain the integrity of the electrical room. The vendor contact for low voltage wiring needs can be found in the Tenant Criteria Package under General Information.

Lighting

Provide a lighting schedule for review in conjunction with a reflected ceiling plan. Lighting must conform to the following guidelines:

1. Display window lighting must be controlled by a time clock and be on during the hours the Shopping Center is open. Display window lighting at the ceiling must be glare-free and at approved levels at the storefront glass line.
2. The Tenant is responsible for all lighting within the Tenant's space. The Tenant will not install any lighting outside the Tenant's space with the exception of Mall required standard lighting at back doors. These fixtures shall be photo cell controlled.
3. Decorative fixtures for storefront illumination, such as

luminous ceilings, chandeliers, pendant or wall units or clear type glitter strips are permitted if approved by Landlord. No strobe, spinner or chase type lighting shall be used.

4. Fluorescent or incandescent light fixtures in Tenant's public areas, other than decorative fixtures, shall be recessed. Fluorescent fixtures shall have deep cell parabolic louvers. Bare lamp fluorescent or incandescent fixtures may be used only in concealed areas and/or stockrooms.
5. Tenant shall provide emergency lighting per code to illuminate stock and/or sales areas and rear exit way during power outage. Emergency lighting shall be battery-operated, twin-head light pack(s) and/or fluorescent fixtures. In public areas, emergency lights shall be concealed.
6. Recessed incandescent down lights may be used.
7. Exit, emergency and night lights must be provided throughout, as determined by governing codes.
8. Fluorescent lighting in the sales area must be recessed and must use metal parabolic louver type lenses with a minimum of 18 cell configuration for a standard 2 x 2 fixture. Bare lamp fluorescent or fluorescent fixtures with acrylic prismatic lenses may be used only in concealed areas or stock rooms.
9. Track lighting may be used if the track is painted to match the ceiling color.

Temporary Power

- 1. The Landlord may provide temporary electrical service to the Tenant at a monthly charge. This charge will be paid as additional monthly rent no later than the date of commencement.
- 2. Temporary wiring needed to work in the space should be connected to the Tenant’s electrical service and not common area outlets.

Reuse of Existing Electrical Systems

- 1. The Tenant will submit a letter to the Landlord from the Tenant’s electrical engineer stating that the existing electrical system is not being altered.
- 2. The Tenant’s electrical engineer will be licensed in the state in which the work is being preformed.

Tenant is responsible for lighting system control, including connection to the Building Management system and connection to the Fire Alarm system. All emergency lighting, exit signs, horns and strobes must be provided by Tenant as required by code.

Material/Equipment Specifications

- 1. Drawings must include complete material specifications, including manufacturer’s name and product number and complete schedules of all equipment and fixtures to be installed.
- 2. All material and equipment must be new and of a commercial grade and must bear Underwriter’s labels where such labeling applies.
- 3. At grade level electrical conduit may be installed at least 4” under the slab and must be in Schedule 40 PVC conduit. But never allowed to be installed in the slab or less than 4” below slab.
- 4. Floor boxes must be watertight.
- 5. Pull boxes or junction boxes must be a minimum of 12 gauge galvanized steel outlets. Boxes in walls must be galvanized pressed steel or case metal. Caulk around boxes to eliminate noise transmission.
- 6. All main and branch feeders and circuitry wiring must be copper. All conductors to have 600 volt insulation type THW, THWN or THHN.
- 7. Convenience receptacles must be specification grade, 120 volt, 20 amps and be grounding type per NEC.
- 8. Manual or magnetic starters, switches, contactors, relays, time switches, safety devices, dimmers and other controls must be commercial type with heavy duty ratings and must be installed in strict conformance with

the manufacturer’s recommendation and applicable codes.

- 9. Any exposed low voltage wiring must be plenum graded.
- 10. All wiring of any type must be installed in conduit or must be armored cable (BX). Armored cable will only be allowed for concealed branch circuit wiring within the demised premises. Exposed and/or open wiring of any kind will not be allowed. Flexible conduits must be used for connections to vibrating equipment.
- 11. Ground to building steel.
- 12. Install transformers below finish ceilings.

MECHANICAL CRITERIA

LOS CERRITOS CENTER

General Design/Construction Coordination

The mechanical criteria is provided for the purpose of designing the Tenant's heating, ventilating and air conditioning system. This criteria is provided for Tenant's Engineer. It is the Tenant's responsibility to verify existing conditions and comply with all applicable codes and standards.

Complete Engineered drawings must be submitted to Landlord's Tenant Coordinator for review and approval. Landlord will review the plans for conformance to basic mall requirements. The Landlord does not review for mechanical design, nor does the Landlord accept responsibility for the Tenant's adherence to governing codes.

Equipment or other obstacles placed in the vicinity of existing solar panels shall follow the guidelines outlined below:

- No equipment shall be placed within 10 feet of any solar inverter or AC junction box
- To avoid interfering with solar panel production, objects shall be placed no closer than the distance defined as 2 times their height. For example, if a 4 foot HVAC unit is installed, it must be located at least 8 feet away from a solar panel.
- In no cases, regardless of the height shall an obstacle be placed within 3 feet of solar equipment
- No conduits, pipes or other devices shall be added to existing conduit carrying devices

- No wires, pipes or other devices will be routed across or over existing solar equipment
- All modifications within 20' of solar equipment shall require review and approval from Macerich personnel

The documents to be submitted for Landlord approval must include the following:

1. Complete plans and specifications covering the heating, ventilating and air conditioning system work. Show make, type and performance of all equipment. Documents must be signed and sealed by a Licensed Engineer in the state where the shopping Center is located.
2. Calculations showing the heating and cooling required, including transmission and ventilation losses in the space and heat and cooling provided for the ventilation supply and exhaust required for the space. Calculations shall be as described in "Load Calculations" included below.
3. Temperature control system data showing make, control and energy management systems.
4. Exhaust system layout, including CFM and equipment specifications.
5. Structural details for support of all roof top equipment and equipment suspended from the steel structure.

Load Calculations

The Tenant must perform all calculations in accordance with methods set forth in the latest American Society of Heating, Refrigeration and Air Conditioning Engineers' Guide and Data Book and in accordance with good engineering practice. All calculations must be tabulated in a concise, orderly manner.

Heating load calculation: All spaces must be calculated to maintain the minimum space temperatures in sales and public spaces of 68 degrees F and 50 degrees F in non-public spaces.

Cooling load calculation: All spaces must be calculated to maintain the minimum space temperature of 73 degrees F and a maximum relative humidity of 55 degrees F and shall take into account all interior heat producing items such as people, equipment, roof and exterior walls.

The Tenant is required to submit calculations indicating the heating and cooling loads for the space and calculations for exhaust and make up air.

Tenants must design for a maximum noise criteria of NC40 for all spaces except kitchens and other similar work areas.

MECHANICAL CRITERIA

LOS CERRITOS CENTER

CONTINUED

Exhaust Requirements

Tenants whose operation produces objectionable odors such as restaurants, pet shops, hair salons, nail salons, and the like must maintain 10% negative air pressure with respect to the Mall by providing make up air equal to 90% exhaust air volume. Tenant may be required to provide, at Landlord's discretion, a separate make up outside air supply system to balance Tenant's exhaust system. Spaces that require exhaust must be designed to provide negative air pressure relative to adjoining conditioned spaces to prevent odor transfer.

Roof mounted exhaust fans must be ducted to ceiling grilles located approximately in the center and rear of the demised premises and specifically near the area where the odors are generated. The system shall be designed to cause the exhaust air to gravitate from the Mall Common Area to the odor producing area and then exhausted out.

- Landlord may require nail shops to install scrubbers. This will be determined on a case by case basis.
- Air filtration systems and bathroom exhaust fans are not acceptable solutions.
- The exhaust fan must be interlocked with the light switches for the store customer service area.
- The combined HVAC and exhaust system must be in operation during all hours that the Tenant is open for business.

Kitchen Exhaust Systems

Kitchen exhaust systems are subject to Landlord's review to ensure the exhaust does not compromise the ventilation air of adjacent mall roof top units. Kitchen exhaust systems are subject to the following criteria:

1. The exhaust fan must be a SWSI centrifugalfan which must be fitted with a minimum 10'-0" stainless steel upblast. Guy wires must be attached to the roof in order to secure the stack. Use the mall roofer for connection of the guy wires.
2. A "Grease Guard" grease containment system (or approved equal) must be installed to protect the Landlord's roof. A quarterly maintenance program must be in-place for the grease containment units. Proof of the maintenance contract must be presented to Landlord prior to the store opening.

Roof Penetrations

If use of roof top units, roof-type supplemental supply, condensing units or exhaust air units by the Tenant is permitted by the Landlord, units must be located on that part of the roof of the building directly above the demised premises as designated by Landlord. Tenant must provide and install all necessary piping and other necessary appurtenances for the operation of the roof top equipment. To the extent any of Tenant's equipment is to be located on the roof, the Tenant agrees to erect roof units in accordance with the require-

ments of the Landlord and the Tenant further agrees to repair any and all damage to the roof and structure caused by hoisting installation and the maintenance and/or servicing of such equipment, all of which must be at the sole cost and expense of the Tenant.

The Tenant must furnish and install all curbs, supports, lintels, pipes, ducts, vent caps, air inlets, exhaust hoods, louvers, flashings, counterflashing, etc. as required for any equipment requiring openings through the roof and/or exterior walls. The use of curb adapters is not allowed.

The Landlord has the right to inspect the quality of the work and approve locations and, if found unsatisfactory, reject same.

All cutting, patching and restoring of roofing is to be done by the Landlord's roofing contractor at the Tenant's expense. All repairs, maintenance and damage to the roof and/or building due to Tenant's installation must be at the Tenant's cost and expense.

Closeout Requirements

1. Tenant must submit as-built drawings and certified air balance reports prior to construction close out showing the exact location of all equipment and duct work.
2. Tenant is required to properly abandon old and unused roof top equipment (HVAC units, exhaust fans, etc.) by full removal, including curb with an appropriate metal

MECHANICAL CRITERIA

LOS CERRITOS CENTER

CONTINUED

deck and roof material patch. All roofing work must be performed by the Mall approved Roofing Contractor.

3. Pavers must be placed around the roof top equipment and from the main pathway to the equipment in order to protect the roof from traffic.

HVAC Information

General Requirements

1. All Tenants that have an HVAC system or systems that total 2,000 cfm or greater must have their duct detection equipment tied into the Malls alarm panel. The installation, equipment and costs of installing said equipment will be the Tenant's responsibility. Said duct detectors and their locations must meet the Mall's required alarm contractor's specifications. The cost associated in monitoring Tenant's space will be the Tenant's responsibility and will be included in Tenants monthly billing.
2. Any new HVAC unit or replacement of an existing HVAC unit or the modification of any structure or substructure supporting the unit(s) shall be designed, engineered and installed at Tenants' sole cost and expense. Tenant shall provide structural engineering calculations and drawings from a licensed structural engineer (Registered in the State of the Center where the work is located) to Landlord for review and approve prior to installation of any unit. All equipment is to be installed over structural members that can support the weight of the equipment in areas designated by Landlord. All recommendations of design and verification of completion shall have the structural engineer's embossed seal from the state.
3. Vibration isolators are required to be installed on all HVAC equipment, whether on the roof or within the Tenants space.
4. All HVAC units shall be bottom fed for supply and return air.
5. All HVAC units shall be equipped with a 120-volt outlet from the Tenant's electrical service mounted to the unit on the rooftop.
6. All condensate lines from HVAC units shall be copper and installed as follows:
 - a. Lines shall be run at right angles and drain into Tenant's space.
 - b. Supports for the condensate lines shall be secured to roof per mall roofer's required specs.
7. The improvements shall in no way diminish or interfere with the structural integrity of the building, roof structure, or with roof drainage.
8. Workmen prior to their leaving the premises should remove all debris, materials, unused parts, etc.
9. All return air is to be ducted from the finished ceiling back to the HVAC unit. Ceiling return air plenum is not acceptable.
10. Fire damper assemblies, (including sleeves and installation procedures) must be UL listed and approved by the building inspector preceding installation. Install duct and ceiling access to fire dampers. Smoke detectors may be required in all return air or exhaust ductwork. The detectors will over ride and shutdown the air handling equipment when smoke is discovered.
11. Fiberglass ducts are not permitted for HVAC trunk lines. Flex duct is permitted for run outs within the Tenant-premises and is limited to a maximum distance of FOUR FEET (4'-0").
12. Exposed ductwork is not allowed on the roof.
13. Balancing of the air conditioning system will be performed by an independent test and balancing agency at the sole cost and expense of the Tenant.
14. Tenant must provide welding blankets to protect Landlords roof during any welding on the roof level. Tenant may be required to use a Deputy Inspector to inspect all welds at the sole cost and expense of the Tenant. All materials, welds, connections, etc. installed by Tenant for the HVAC system must be coated to withstand corrosion.
15. No improvements will be installed during inclement weather. Tie-in of flashing materials to moist or dusty-surfaces should not be attempted. Existing materials, as well as all metal or concrete surfaces, should be cleaned prior to application of new materials.

MECHANICAL CRITERIA

LOS CERRITOS CENTER

CONTINUED

16. All electrical conduit, metal pipe, or plastic piping should be restrained to appropriate sized wood blocking set into roofing cement. Attachment to blocking should allow for movement due to thermal expansion and contraction. (See attached Detail.)
17. Platforms, curbs, and sleepers are to be tied into the existing roof membrane by the landlord's approved roofing contractor, at the sole cost of the Tenant, in a manner acceptable to the roofing manufacturer and the Landlord.
18. Provide new prefabricated lead or metal pipe sleeve flashing to seal any new pipe penetrations through the roof. Flashing flanges should be installed in a manner acceptable to the roofing manufacturer and the Landlord.
19. When multiple A/C refrigeration lines penetrate the roof, a weatherhead must be used.
20. All Tenants are to have duct detectors installed in their HVAC system. JMG is the Mall's required vendor for installation, permitting and monitoring. Contact Andy Schimmel of JMG at (714) 545-8882.

Structural Considerations:

1. The Tenant must retain a Structural Engineer, registered in the state in which the work is being performed.
2. The Tenant's structural engineer must examine the existing structure and determine the location for roof top equipment placement.
3. The Tenant's engineer will provide the Landlord with a recommendation for the support of roof top equipment.
4. Locate roof top equipment over major structural elements.
5. Reinforce the roof system to adequately support the weight of any equipment added.
6. No structural or miscellaneous bridging, blocking, etc., may be removed.
7. The Landlord must approve any modifications required before work begins.
8. Upon completion, the Tenant's structural engineer shall submit a letter stating that the roof top equipment has been installed in accordance with the engineer's recommended design.
9. Existing rooftop equipment that is not being used by the Tenant shall be removed and disposed of at the Tenant's expense.

Location & Installation of Roof Top Equipment

1. Locate all roof top equipment as far from side walls as possible. Roof top equipment will not be visible from the parking lot or adjacent streets.
 - a. Distance between Fresh Air Intake and Exhaust units shall be a minimum of 15'-0"
 - b. It is the sole responsibility to design and locate the distance such that Tenant's exhaust cannot be drawn into the Fresh Air Intake of ANY existing roof top equipment.
2. Factory curbs are required for the installation of all roof top equipment. Curbs must be a minimum of eight inches high.
3. Roof penetrations may not be located so close to one another that they interfere with proper flashing, or be installed in any roof waterway or area of the roof which ponds water. If placement of any curb or platform causes restriction of water flow and/or creates a ponding situation, a cricket will be constructed at the upslope side of the curb. Crickets can be formed from Perlite roof insulation to provide a minimum slope of 1/4" per foot.
4. Roof penetration for control and electrical wiring shall be made through the equipment curb or roofer required flashing.
5. The distance between the new improvements and parapet walls, existing equipment curbs, or any rooftop pro-

MECHANICAL CRITERIA

LOS CERRITOS CENTER

CONTINUED

jection, should be no less than 24" to allow for proper flashing and sealing of the roof membrane.

6. The Tenant's name and suite number will be stenciled on the HVAC unit as designated by Mall Management Office.
7. All support blocking must be wrapped in Mall approved roofing material.
8. Roof mounted equipment cannot be visible from the parking lot. Equipment must be screened per city requirements. See diagram on page t13 of this criteria.

Criteria for Reuse of Existing HVAC Roof Top Units

The lease may allow some Tenant's to reuse an existing HVAC system located in their Tenant space. In such cases the Tenant will proceed as follows:

1. The Tenant must establish that the existing HVAC installation conforms to the Landlords criteria.
2. Should the Tenant choose to reuse an existing HVAC unit and the Landlord determines that a new unit is required for any reason, at any time during the term of the lease, the Tenant must install a new unit conforming to the Landlord's criteria

GENERAL NOTES:

- A. Tenant may not reuse an HVAC unit 5 years old or over. If the existing unit is in excess of 5 years old, a new unit shall be installed in accordance with the Landlord's criteria, at the sole cost of the Tenant.
- B. When reusing an existing HVAC system the Tenant is in no way relieved of the responsibility to conform to the Landlords criteria governing the HVAC.
- C. The Tenant may not alter the existing HVAC system in any way without first submitting plans for approval.
- D. Prior to opening, the Tenant will submit the following documentation; (i) a letter from the HVAC Contractor asserting that the HVAC unit is operating in "like-new" condition, (ii) a copy of the maintenance agreement for unit(s) to the Landlord, (iii) the Tenant's HVAC maintenance contractor must provide photographs of the existing unit(s).

Odor Producing Tenants / Exhaust Systems

1. The following special requirements apply to odor producing Tenants, (including but not limited to hairstyle shops, pet-shops, restaurants or fast food use shops, and any other at Landlords discretion).
2. Odor producing area - Tenant is required to furnish and install the necessary equipment to remove any odors. This work will be approved in writing by the Landlord and at the sole expense of the Tenant. Examples of such Tenant's include; hair or nail shops, pet shops, and food preparation shops.
3. Use motor driven and factory curb Supreme upblast roof ventilator model installed at a minimum of 40" from roof membrane to discharge. Use a gauge welded exhaust duct. Provide makeup air as noted below, but not less than 85% of amount of exhaust.
4. The Tenant, as required by special conditions such as grills, restaurant exhaust systems, etc., will provide special makeup air. Along with the HVAC unit, the Tenant may use an evaporative cooler
5. Smoke detectors may be required in all return air or exhaust ductwork to over ride the air handling equipment and provide shutdown when smoke reaches the equipment.

Additional Requirements for Restaurants:

1. Sizes and locations for all duct and piping through roof must be shown on plans. Show all required fireproofing.
2. All garbage and refuse areas wash down “grey” water must be contained and properly drained off into city approved system (i.e.. sewer or storm).
3. If the Tenant engages in the preparation of food or baked goods, Tenant agrees, at Tenant’s expense to do the following:
4. Install dry chemical extinguishing devices (such as ansul) approved by the fire insurance rating organization carriers.
5. Maintain all exhaust ducts and filters in a clean condition.
6. Place and store Tenant’s garbage and refuse in containers which shall be kept, until collected, in a self-contained area within the demised premises set aside for the storage of garbage and/or storing of inflammable or combustible materials, Tenant agrees to install and maintain appropriate chemical extinguishing devices.
7. In the event gas is used in the demised premises, Tenant agrees to install an appropriate gas cutoff valve.
8. Should the Tenant fail to install any such devices referred to in this section and/or to subscribe to the servicing thereof, Landlord shall have the right to enter the demised premises and to make any necessary instal-

lations and charge the cost of such installations and/or the servicing thereof to Tenant which Tenant agrees to pay to Landlord, as additional rent, within ten (10) days after demand.

General Design/Construction Coordination

The following criteria is provided for the purpose of designing the Tenant's plumbing system. This criteria is provided for Tenant's Engineer. It is the Tenant's responsibility to verify existing conditions and comply with all applicable codes and standards.

Complete Engineered drawings must be submitted to Landlord's Tenant Coordinator for review and approval. Landlord will review the plans for conformance to basic mall requirements. The Landlord does not review for plumbing design, nor does the Landlord accept responsibility for the Tenant's adherence to governing codes.

The documents to be submitted for Landlord approval must include the following:

- Complete plans and specifications covering the complete plumbing system. Documents must be signed and sealed by a Licensed Engineer in the state where the Shopping Center is located.

The Tenant shall provide a complete plumbing system for the Tenant space. The Landlord has provided connections in each tenant space for sanitary waste and potable cold water. See page t13 for exact plumbing items provided by Landlord for Nordstrom's area small shops.

Tenant is responsible for all plumbing including toilets, sinks, urinals, drains, hot water heaters, water coolers and

connections into existing water and sewer lines.

Water Efficiency

1. The Tenant is required to install waterless urinals in tenant restrooms when urinals are used.
2. Low-Flow water closets using 1.6 GPF or less gallons per flush will be installed in all tenant spaces.
3. Operation sensors and low-flow heads using 0.5 GPM or less in lavatories.

Tenant shall provide a main water shut off valve located at eye level in a wall behind a labelled access door. Locate in or near employee restroom as designated by Landlord.

All domestic supply lines shall be copper. Sanitary and vent lines traversing the ceiling area to be cast iron or copper (no PVC). Tenant will utilize electric water heaters for domestic hot water.

Every Tenant must install a handicapped restroom facility with a minimum of one water closet and one lavatory and in accordance with local code officials. An exception to this requirement is only permitted for Food Court Tenants who are within close proximity to the public restrooms upon approval of the Landlord and local code official.

A water meter to measure the amount of water used must be installed by the Tenant below the lavatory. If applicable,

second level restrooms must install a 3" floor drain. Mop sinks and water fountains must be installed per local code requirements.

Tenant must install clean outs as required by code and Landlord's requirements and these shall terminate flush with the finish floor or wall. No clean outs are permitted above the ceiling.

Garbage disposals are not allowed.

Hair salons and pet shops shall provide hair and solids interceptors on all sinks and basins which may receive human or animal hair. After installation, these hair interceptors shall be properly maintained so as to keep the sanitary system free from any adverse conditions.

Except with Landlord's prior written permission for non-compliance, all pot sinks, scullery sinks, pre-wash sinks and other kitchen units must be connected to a grease trap. Dishwashers may not be connected to grease trap.

Waterproofing must be installed in all "wet areas" such as kitchens, restrooms, mop sinks, drinking fountains, etc. The waterproof membrane must extend 4" vertically on all demising walls. This membrane will be water tested by the General Contractor and inspected and signed off by Mall Personnel. If the membrane fails the water test, it must be replaced.

PLUMBING CRITERIA

LOS CERRITOS CENTER

CONTINUED

Food service, hair salons and photographic processing or other Tenants with equipment or operations that have the possibility of backflow will be required to install an approved backflow preventer. These must be certified and acceptable to the water district and checked yearly or as required by the local authority having jurisdiction.

Tenants must submit calculations to the Landlord which show the size selection or basis of capacity of all equipment and piping.

All waste piping designed and installed for the discharge of material from kitchen equipment, except dishwashers, shall discharge through a grease interceptor provided and installed by tenant prior to connection to mall's sanitary system. Grease interceptors shall be contained completely within the demised premises and above the floor slab or in other landlord approved location.

Gas Service

All new development and newly Tenanted restaurants need to have seismic gas shut-off valves installed on Landlord side of the meter, at each individual space. Seismic valves must be:

1. UL-approved;
2. FM-approved; or,
3. ACSE 25-compliant.

All devices must be installed consistent with manufacturer's instructions and following jurisdictional code.

Gas may be available at the center. Tenant, at its sole cost and expense and in compliance with local code must procure gas service to and within the demised premises and will make all necessary arrangements with the local Gas Company for such service. Tenant is responsible for installation of a gas meter at the gas meter header.

Pressure regulators and piping required for connection to Tenant's equipment is the responsibility of the Tenant. Coordinate with Landlord for regulator vent routing.

Gas piping on the roof must be placed on pillow blocks or similar arrangement.

Seismic Gas Shutoff Valve

All Tenants who use or have a gas line installed for their premises, or equipment that serves their premises, are required to install a code and Landlord-compliant seismic gas shut off valve on the main gas line serving the space.

Ventilation

Tenants will provide vertical exhaust ducts at a location designated by Landlord. All hood exhaust must be connected to vertical duct in accordance with code. Tenants are required to provide for the upkeep and maintenance for such vertical exhaust duct and related devices and materials.

All sanitary sewer and plumbing vent piping shall comply with all local codes.

Vents through the roof shall be a minimum of 4" and extend a minimum of 8" above finish roof.

The following criteria is provided for the purpose of designing the Tenant’s structural drawings. This criteria is provided as a guideline for Tenant’s Engineer. It is the Tenant’s responsibility to verify existing conditions and comply with all applicable codes and standards.

Complete Engineered drawings must be submitted to the Landlord’s Tenant Coordinator for review and approval. Landlord will review the plans for conformance to basic mall requirements. The Landlord does not review for design, nor does the Landlord accept responsibility for the Tenant’s adherence to governing codes.

The documents to be submitted for Landlord approval must include the following:

- Complete plans and specifications for all structural work. Documents must be signed and sealed by a Licensed Engineer in the state where the Shopping Center is located.

General Requirements

1. The Tenant’s storefront must be structurally self-supported. Tenant may not support the storefront from the bulkhead or fascia. Structural support for Tenant storefronts must be from the roof joists for lateral bracing.
2. Fixtures and equipment may not be attached to or supported from the floor or roof deck.
3. Structural drawings are required for all items that require support from the steel structure or for all roof top equipment weighing 300 lbs or more.
4. Joist reinforcing is required for roof top equipment as well as steel support for all roof openings.
5. Upper level Tenant’s must review base building structural drawings prior to installing a security safe, ovens or any equipment weighing 300 lbs. or more.

Exit Corridor

Distribution of utilities through a newly constructed or an altered exit passageway is prohibited except for equipment and ductwork specifically serving the exit passageway, sprinkler piping, standpipes, electrical raceway for fire department communication and electrical raceway serving the exit passageway.

FIRE-LIFE SAFETY CRITERIA

LOS CERRITOS CENTER

1. Tenant must provide a complete fire alarm detection system within the Tenant space separate of the Landlord's building-wide addressable fire alarm system.
2. If applicable, Tenant is required to use Landlord's designated contractor for installation of the necessary smoke detectors and connection to the main fire alarm system. System must comply with the requirements of the governing authority.
3. All emergency lighting, exit signs, horns and strobes must be provided by Tenant as required by code.

Fire Protection/Sprinkler System Information

1. All sprinkler modification work will be performed by the Landlord's required contractor for the Tenant at the Tenant's expense.
2. Equipment:
 - a. Standard sprinkler heads in areas without ceilings will be quick response upright bronze heads.
 - b. Standard sprinkler heads in areas with finished ceilings will be quick response semi-recessed chrome heads.
 - c. Flush mounted heads are required throughout the DCA.
 - d. The Tenant should contact the local or state fire marshal for specific requirements relating to quantity and location of fire extinguishers. At minimum, Tenant is to install at least one wall hung, 2A 10BC

- dry type U.L.- listed fire extinguisher.
- e. Keep all piping as close to walls and as high to underside of roof framing as possible.
 - f. Required Duct Detector: Any HVAC unit 2000 CFM or larger, is required to have a smoke duct detector in the air supply & return of each unit. The duct detector must have remote test and alarm indicator station per city code.
 - g. Contractor must also submit plans to the Fire Prevention Bureau for approval. The Tenant/Tenant's Contractor is responsible for all city testing and inspection fees.
 - h. If required, Tenants will furnish and install their own complete fire alarm system that is compatible with the Landlord's system. Tenant is responsible for any devices and connection costs as may be required to interface with the Landlord's system with all work performed at the Tenant's expense for any portion of the monitoring system, whether inside or outside the Tenant premises.
 - i. Contractor shall notify the Landlord in writing at least 24 hours in advance of making any modifications to the sprinkler systems. Contractor must notify the fire department and any alarm monitoring company for verification that the system is fully drained. The contractor must notify the Landlord when the system is back on line.

- j. In order to clear alarms, contractor shall contact security or Mall maintenance supervisor at least 60 minutes prior to any drain down. Contractor shall remain for one (1) hour after the system has been refilled to check for leaks or other problems.
- k. No system will be left to drain over night. All systems have to be charged and operational when worker leave for the night.
- l. Keep all piping as close to walls and as high to underside of roof framing as possible.

Drawings

1. Fire Protection/Sprinkler Drawings shall include a reflected ceiling plan, with revised sprinkler head locations.
2. A copy of the Tenant's store plans will be sent to the Landlord's sprinkler contractor for review to insure that the system is adequate for the space as designed.

Procedures

All work on the Sprinkler Fire System must be done between the hours of 7:00 AM and 4:00 PM Monday through Friday, so the fire system can be filled and tested by 5:00 PM. A cost of \$250.00 for each shut down of the system is required to be paid before the system is drained. The Mall staff or approved contractor will drain and fill the system.

TECHNICAL CRITERIA ADDENDUM

LOS CERRITOS CENTER

CONTINUED

Nordstrom's Expansion

Landlord to provide for Small Shops - Non-Restaurant Use

- Provide 6" metal studs between the demised spaces from floor to underside of roof in accordance with the project documents.
- Provide X type 5/8" gypsum drywall board on common area side of stud.
- Provide all fire-proof caulking and sealing where other Landlord installed elements pass through fire-rated walls or assemblies in common areas only.
- Provide a conduit with pull string from the electrical room to the demised space by code.
- Work shall include all work within the electrical room to deliver a power supply (15 watts per s.f.) to the demised space. Note that the power supply shall be 3 phase, 4 wire 277/480 volt.
- Provide a conduit with pull string from the telephone distribution panel to the demised space by code.
- Provide a 3/4" domestic water tap from the existing domestic water main. Such tap shall terminate in a valve and cap.
- Landlord will provide the Fire Sprinkler stub only and the Tenant will provide and install the grid. If the Landlord provides the sprinkler heads, etc., the

Landlord will recapture the cost from the Tenant at \$6.00 p.s.f. minimum.

- Provide 4" capped sanitary sewer stub from existing sewer main within the premises the location of which shall be determined by the Owner.
- Landlord is not required to provide gas to In-Line food Tenants.

ALL UTILITY LOCATIONS WITHIN THE TENANT SPACES TO BE DETERMINED BY THE LANDLORD.

Requirements for Roof Mounted Equipment

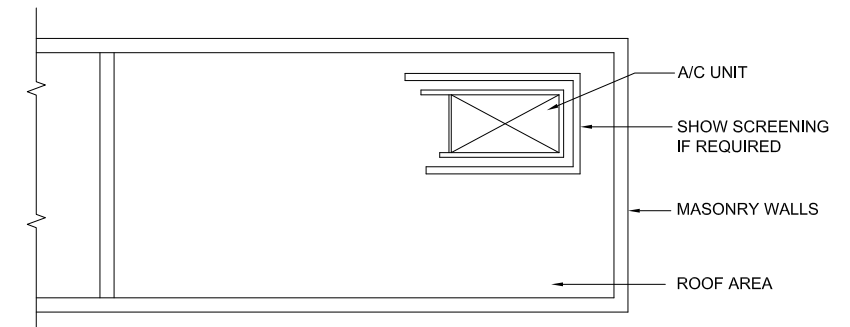

ROOF PLAN

SCALE: N.T.S.

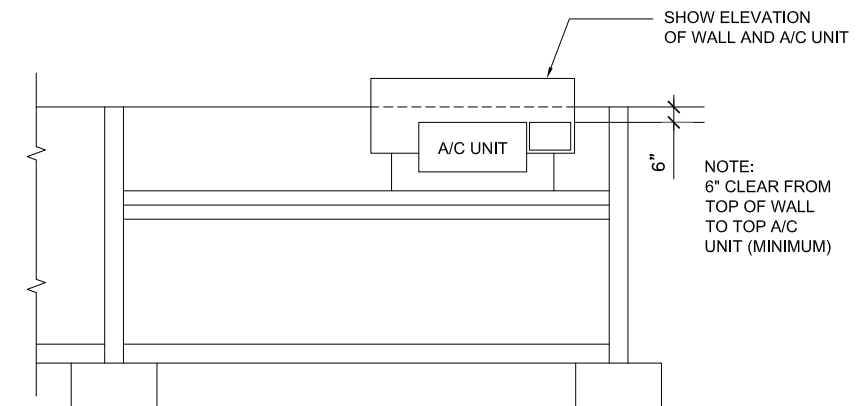

BUILDING SECTION:

SCALE: N.T.S.

NOTE:
ROOFTOP SCREENS MUST BE
DESIGNED TO BE ARCHITECTURALLY
COMPARABLE WITH THE BUILDING

PROVIDE:

1. DRAWINGS SIMILAR TO THE ABOVE
2. STRUCTURAL DETAILS OF SCREEN (WIDE RIB, CORRUGATED METAL-HORIZONTAL) IF SCREEN IS REQUIRED. SCREEN SHOULD MATCH THE COLOR OF BUILDING
3. A/C SPECIFICATIONS.